

Doppler Pendant

ASSEMBLY INSTRUCTIONS



Attention: Read and understand these instructions before installing fixture. This fixture is intended for installation in accordance with National Electric Code and local regulation : to assure full compliance with local code and regulations, check with your local electric inspector before installation. This equipment is guaranteed only when used as indicated in the instructions; therefore they should be kept for future reference. Install where luminaire will be protected from likely damage. This fixture is ceiling mounted only.

YOUR BOX SHOULD CONTAIN

- 2x hollow studs
- 1x universal plate
- 1x cap

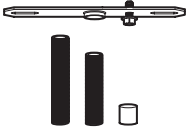

- 1x assembled luminaire

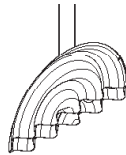

- 2x cotton gloves



TOOLS NEEDED, NOT INCLUDED

- Junction box and screw
- Wire connectors
- Flat screwdriver
- Phillips screwdriver

1 Screw the appropriate hollow stud in the universal plate.

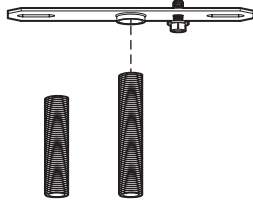

Unpack all components from the box and dispose of the packaging. Please recycle.

2 Use appropriate anchors and screws to fasten the universal plate for your installation.

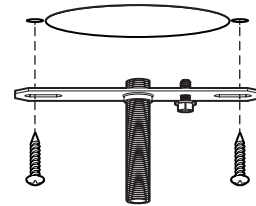

3 First, connect the junction box ground to the green screw on the mounting plate.

Then, connect the live and neutral wires. If the installation requires it, connect the Dali dimming wires.

(Shut off main power at the circuit breaker panel)

Ceiling wires	Fixture wires	For Dali dimming 220V only
Live	120V Black	220V Brown
Neutral	White	Blue
Ground	Green screw	
		Purple + DC+
		Grey - DC-

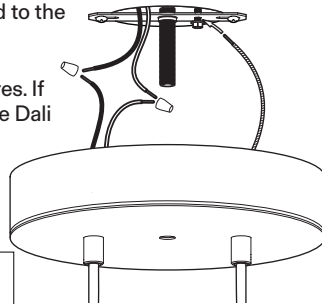

4 Push up the canopy to the ceiling.

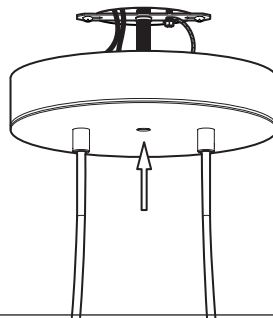

5 Screw the cap to the hollow stud to secure the canopy.

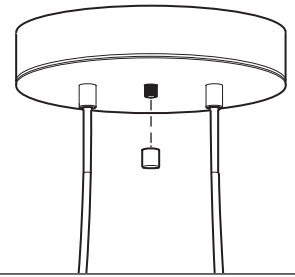

6 Carefully lift the luminaire, holding it on both sides so that there is no longer tension in the wires.

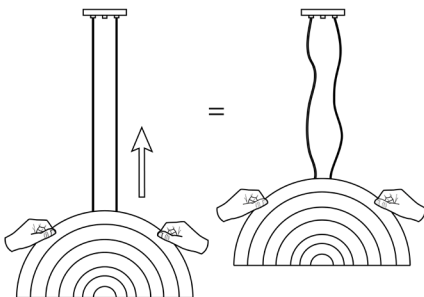

7 Rotate the luminaire to the desired angle

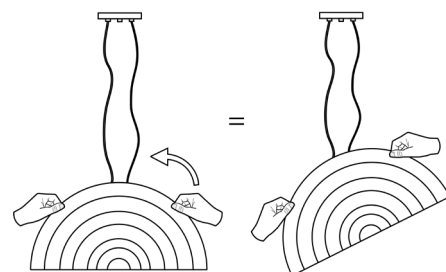

Doppler Pendant

ASSEMBLY INSTRUCTIONS



Attention: Read and understand these instructions before installing fixture. This fixture is intended for installation in accordance with National Electric Code and local regulation : to assure full compliance with local code and regulations, check with your local electric inspector before installation. This equipment is guaranteed only when used as indicated in the instructions; therefore they should be kept for future reference. Install where luminaire will be protected from likely damage. This fixture is ceiling mounted only.

- 8 Gently release the luminaire in the desired position making sure the wires are taut again.

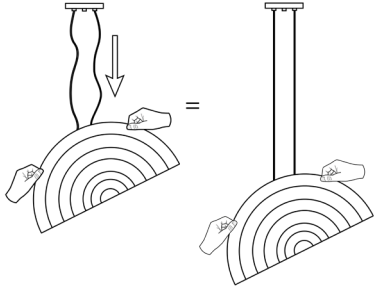

- 9 Adjust the cables by unscrewing the strain reliefs under the canopy.

Once adjustment is done tighten back the strain reliefs.

