

# Doppler Wall

## ASSEMBLY INSTRUCTIONS



Attention: Read and understand these instructions before installing fixture. This fixture is intended for installation in accordance with National Electric Code and local regulation : to assure full compliance with local code and regulations, check with your local electric inspector before installation. This equipment is guaranteed only when used as indicated in the instructions; therefore they should be kept for future reference. Install where luminaire will be protected from likely damage. This fixture is ceiling mounted only.

### YOUR BOX SHOULD CONTAIN

1x universal plate

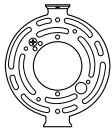

1x assembled luminaire

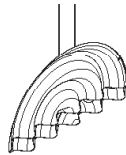

2x cotton gloves



### TOOLS NEEDED, NOT INCLUDED

- Junction box and screw
- Wire connectors
- Flat screwdriver
- Phillips screwdriver

1 Screw the universal plate.



Unpack all components from the box and dispose of the packaging. Please recycle.



2 Use appropriate anchors and screws to fasten the universal plate for your installation.

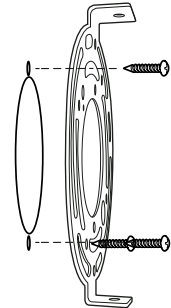

3 First, connect the junction box ground to the green screw on the mounting plate.

Then, connect the live and neutral wires.

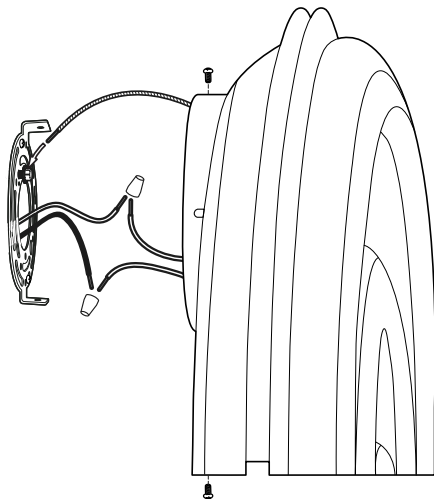

(Shut off main power at the circuit breaker panel)

Ceiling wires	Fixture wires	120V	220V
Live	Black	Brown	
Neutral	White	Blue	
Ground		Green screw	

4 Choose the orientation of your lamp, even diagonally is possible, then plan the position of the support bracket accordingly to it.

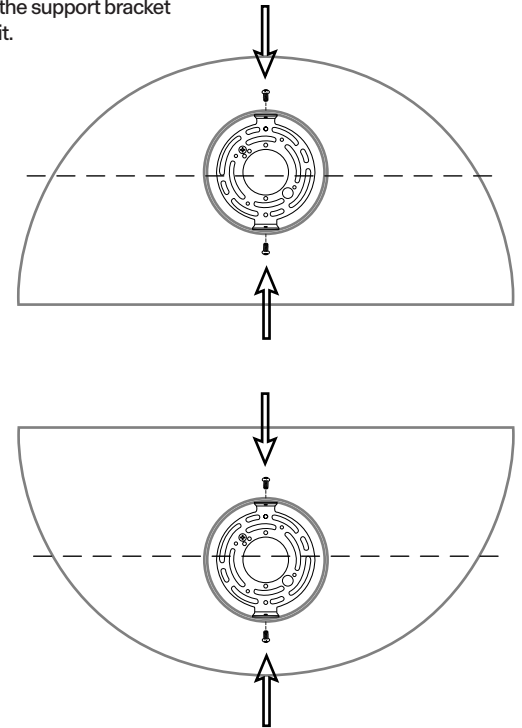

To make it easier, screw the back of your lamp, favoring the bottom and top holes.